



# **The Botswana International University of Science and Technology**

**Prof David Wilmoth**  
**Australia Africa Business Council**  
**28 March 2008**

# Outline of presentation

- **About Botswana**
- **Background to Botswana's second university**
- **IFC and Australian transaction advisers**
- **Academic and institutional plans**
- **Campus master planning**
- **Procurement options**
- **Current state of play**

# About Botswana



- 1.8m people in 600k km<sup>2</sup>
- Success story of Africa: consistently top transparency index, competitiveness index, sovereign risk ratings (famously = Japan), harmonious
- But very high HIV/AIDS incidence
- Diamonds + tourism + good governance = sovereign wealth
- Not so high on technology and innovation indicators but want to develop knowledge industries
- Exceptionally high commitment to education; new openly competitive tertiary education system

# Orientation

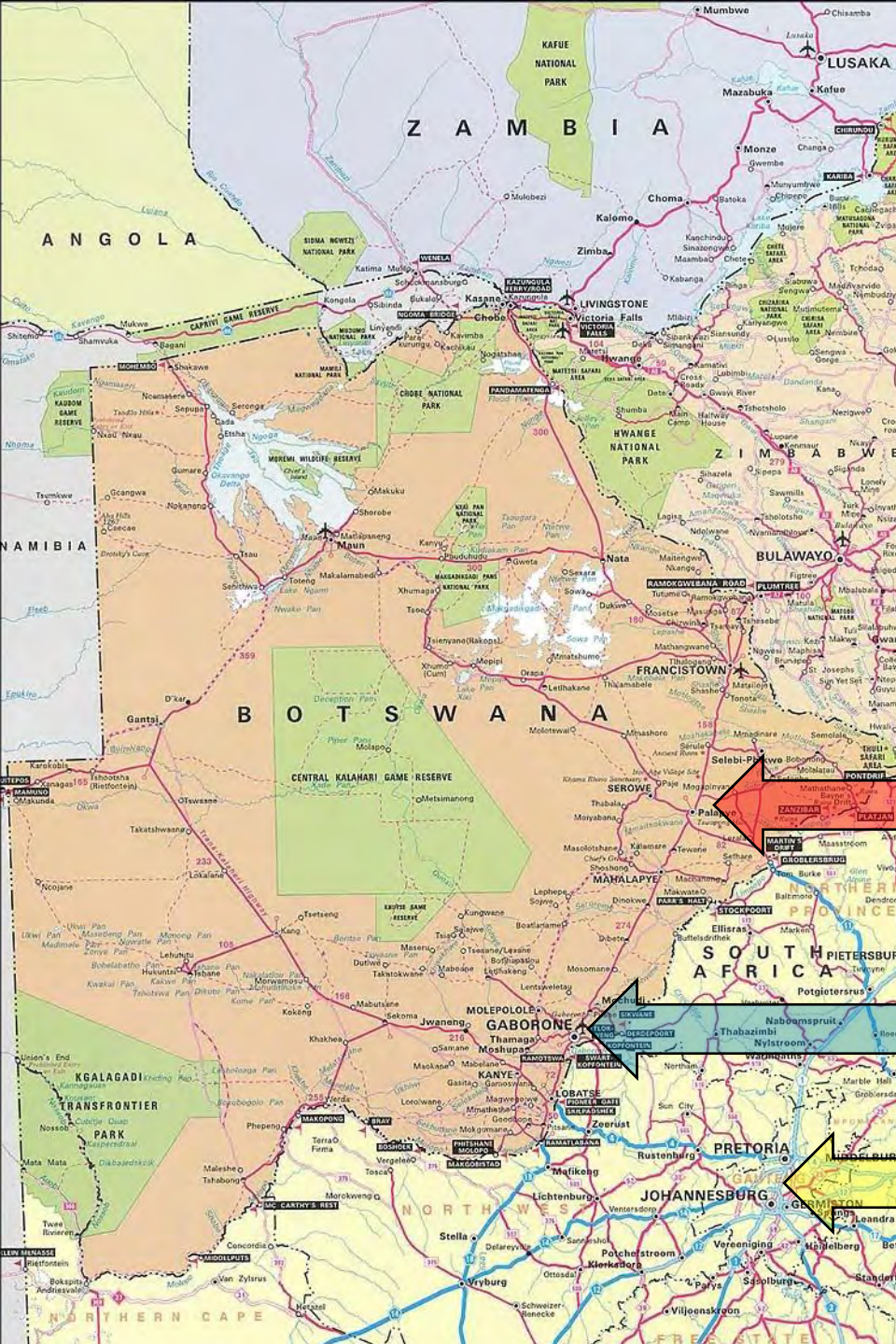

Palapye (BIUST)

Gaborone (capital)

Johannesburg

# **Rationale for the university**

- **Acute skills shortages including engineers, technologists**
- **Cost of universal tertiary education's overseas component very high**
- **Need skills and innovation for advanced industries**
- **Aim to be an international education hub**
- **Social inclusion and equity**
- **Regional development**

# University start-up

- Foreshadowed in national development plans
- Prefeasibility via 2004 Task Force estimated equivalent of USD 1.5 bn project cost
- Palapye chosen as site though not the recommended one
- Legislation passed 2005 to create the university
- Interim Council, implementation team
- Government prepared to underwrite new institution but seek PPP if viable

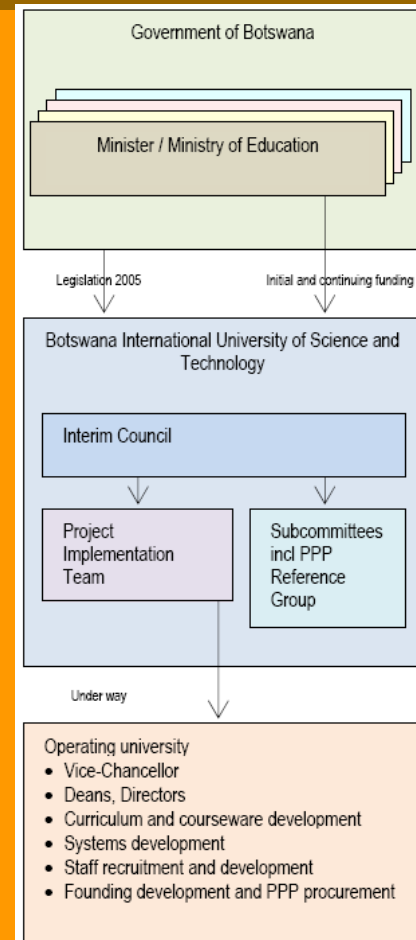

# Transaction advising for a PPP

- PPP procurement for full universities only recent; and limited experience in Botswana
- IFC appointed as transaction adviser
- IFC engages team of Learning Cities International, CM+ (Sydney), Ascon Africa and others
- Staged for speed to undertake
  - High-level analysis of PPP options
  - Feasibility study of chosen option
  - Value assessment PSC of PPP risk-adjusted
  - Procurement of development

# BIUST Project Team



# Academic Strategy

- 'New generation university' with stakeholder engagement, problem-based learning, high-tech, strong research, industry relevance, international students and scholars, access and equity
- Discipline clusters:
  - Engineering
  - Technology
  - Natural and physical sciences
  - Management
- Academic, organisation and HR systems now under design
- Rapid growth from 256 students FTE year 2 to 10,000 year 12, 15% post-grad

# Student growth profile

BIUST Discipline Share (Students FTE)

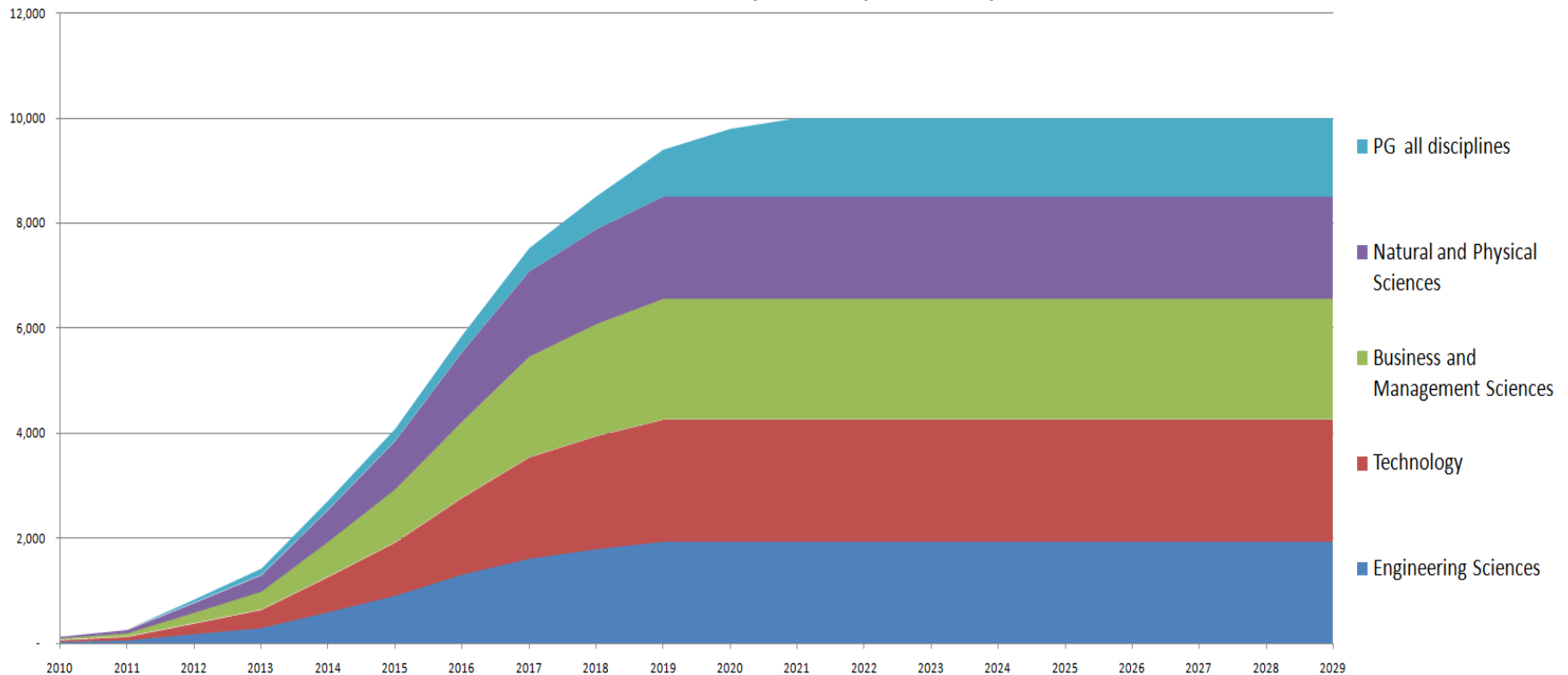

# Graduate and research focus

- Development of graduate programs to respond to demands for regional upskilling requiring international standard learning environment in campus plan
- For both teaching and research, major investment in e-learning, teleconferencing, virtual labs and advanced research infrastructure
- Early development of research centres at international standards with corporate and academic partners, in a number possible fields:
- All research fields to be mission-oriented, address industry problems and produce commercialisable research

# Palapye and BIUST

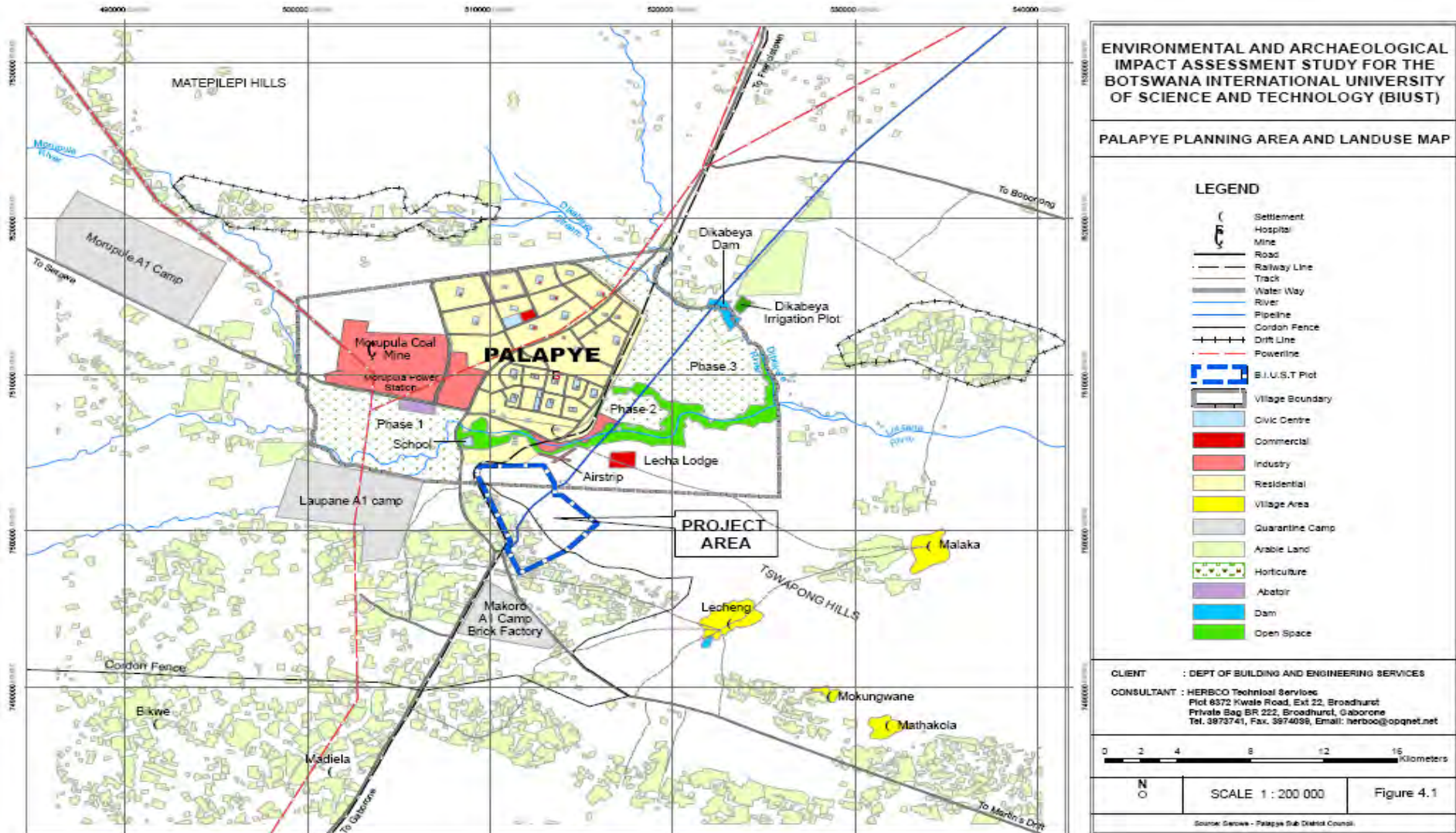

# BIUST site

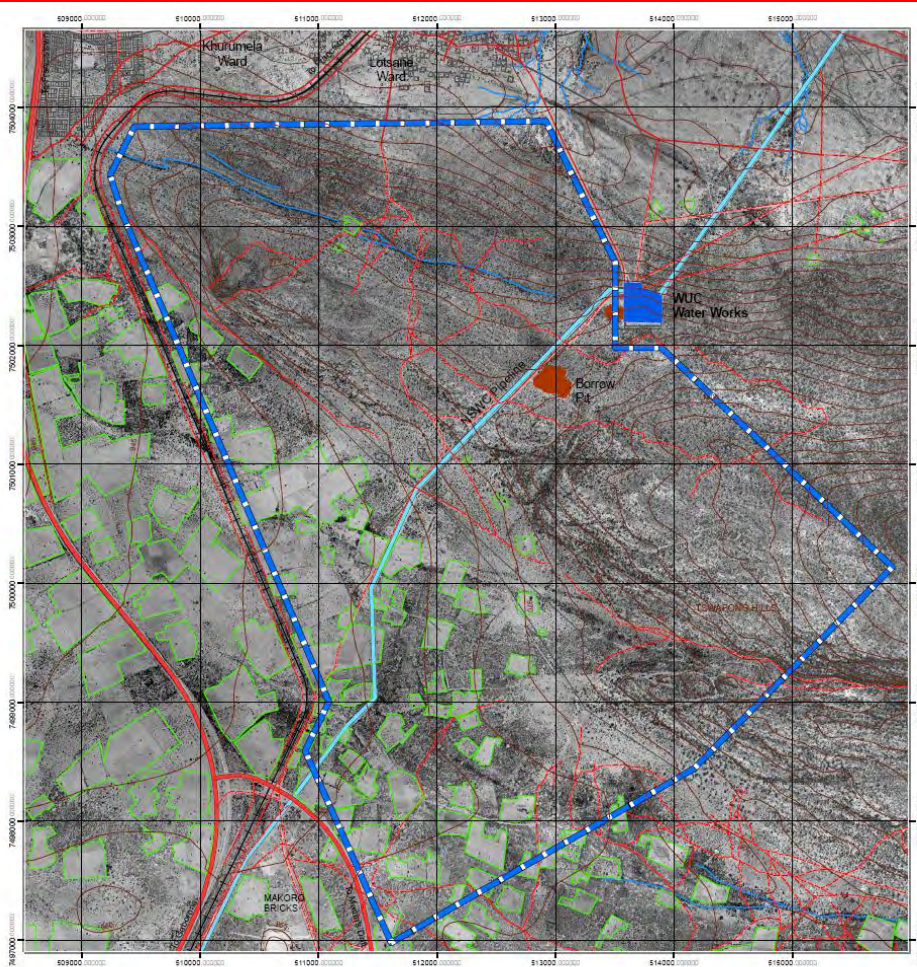

# View of campus site



# View of campus site



# Campus master planning

- 2500 ha plain and hilltop setting
- Academic, ancillary and 'non-academic' business roles to be provided for (resort, hotels, tech park, urban development etc)
- Housing for students, staff and visitors
- Howard University role
- Design grounded in Botswana cultures
- Palapye 30k population growing fast; linkages
- Business zone; Social amenity zone

# Campus master planning

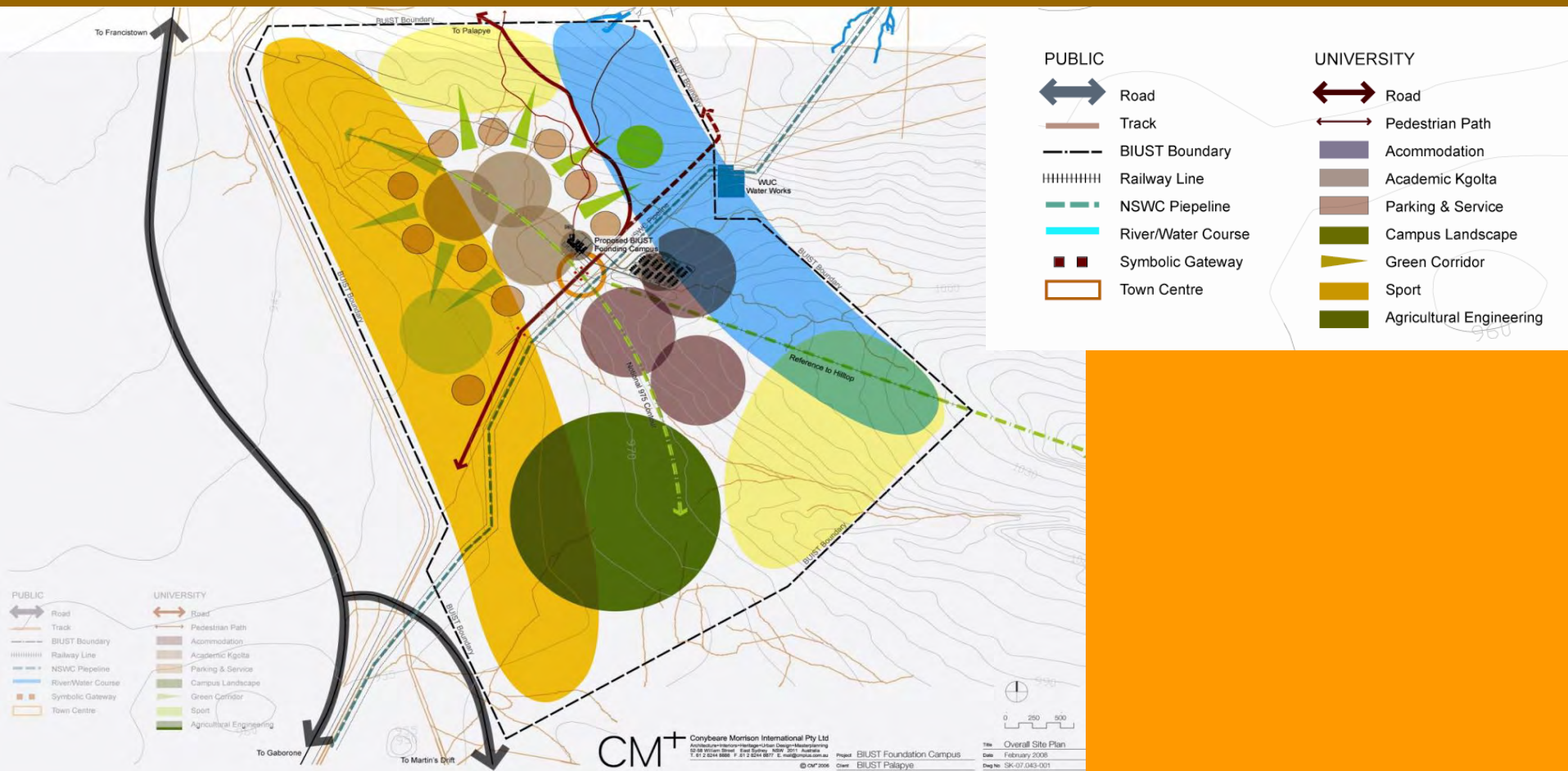



# Costs estimated 2004

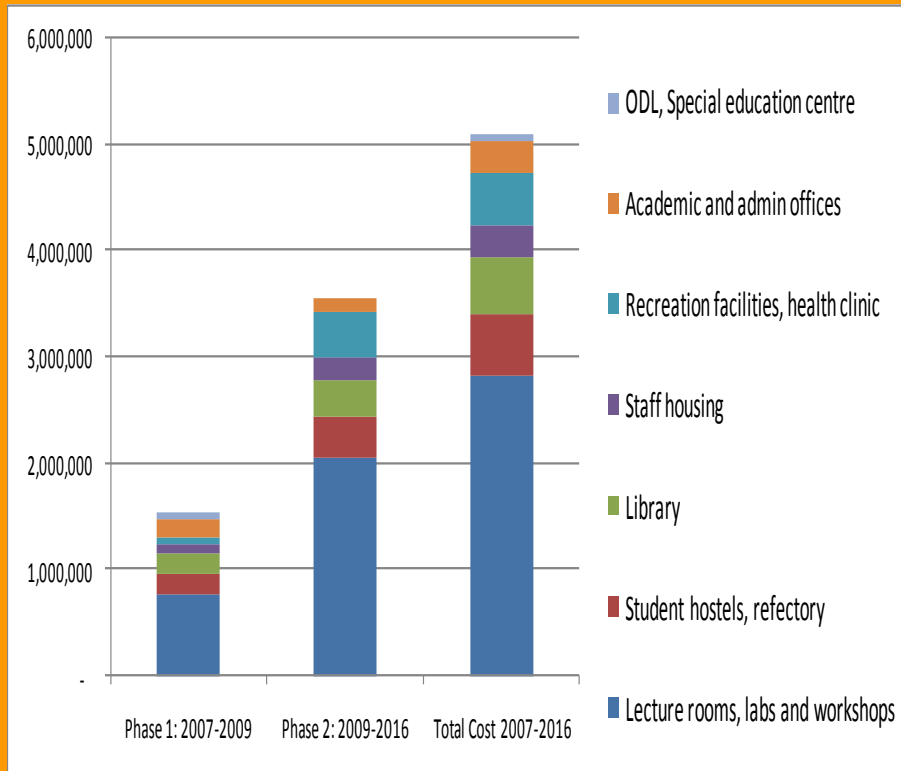

**BIUST Capital Cost 2007-2016 (2004 Pula '000)**  
 (Source: 2004 Task Force)

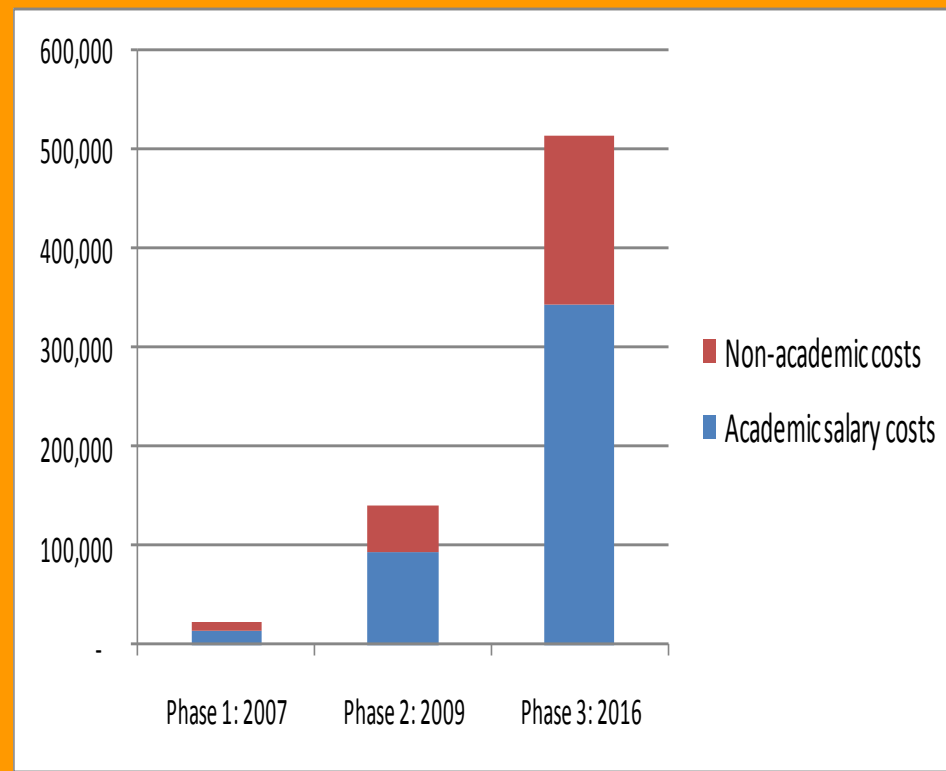

**BIUST Recurrent Cost 2007-2016 (2004 Pula '000)**  
 (Source: 2004 Task Force)

# Project governance and process

- Clear draft policy and procedures based on RSA and Victorian practice
- BIUST Council establishes a Procurement Reference Group
- For PPP Government needs to be satisfied on Affordability, Feasibility and Value for Money
- Very fast PPP track: EOI invitations closed 24 March; seeking financial close end of 2008
- But even faster phase 1 through direct design construct project
- BIUST building its own capacity fast

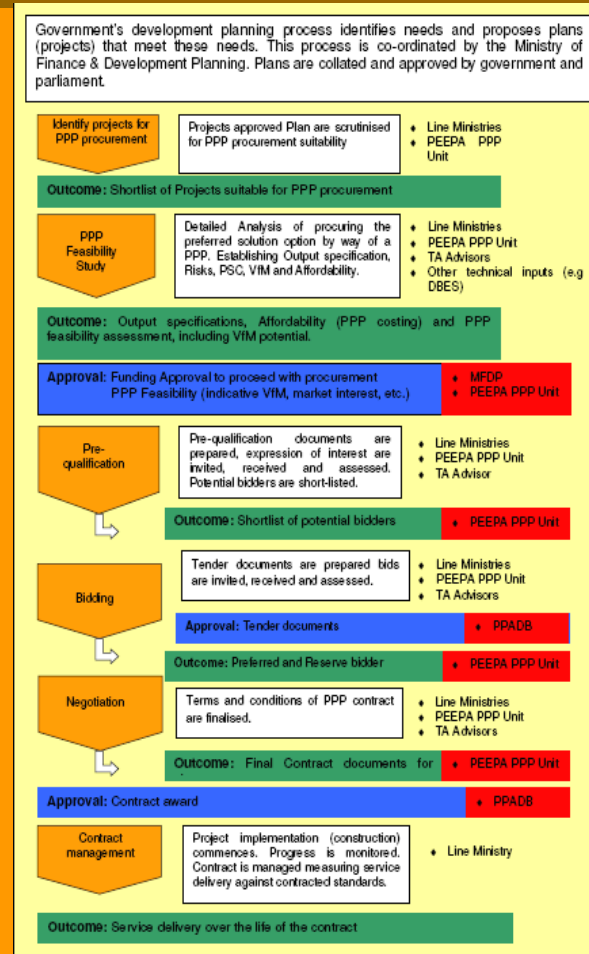

# BIUST procurement options

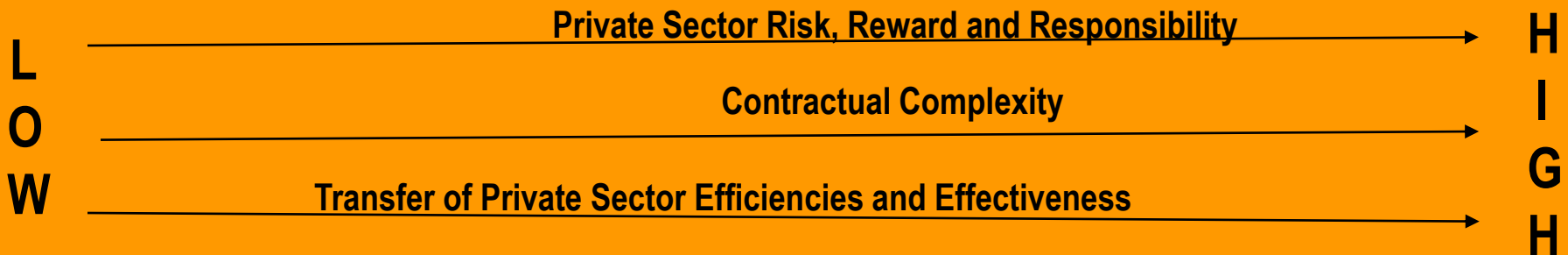
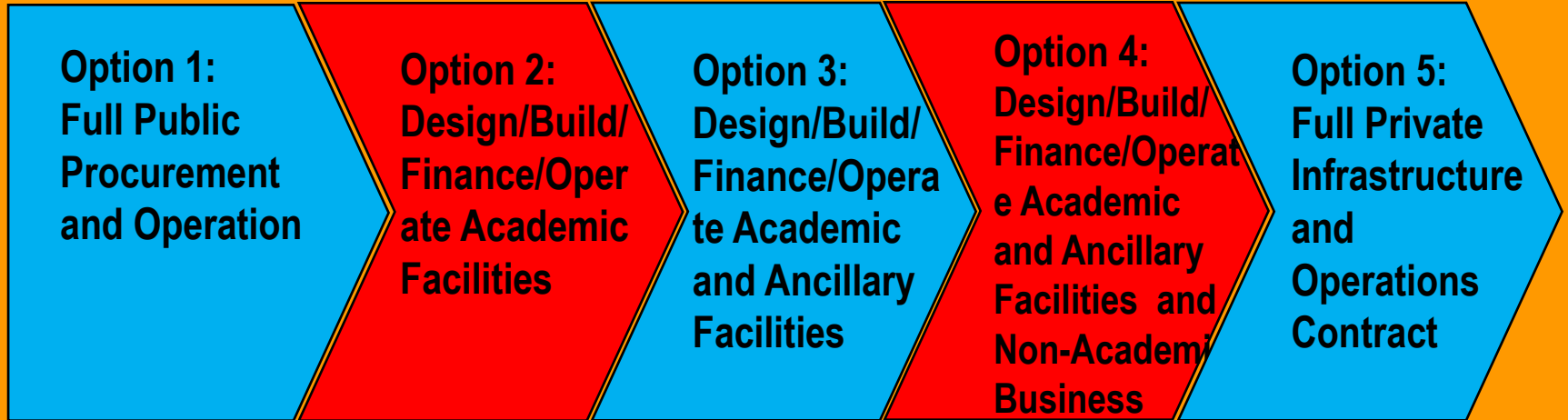

# Value assessment: affordability and value for money

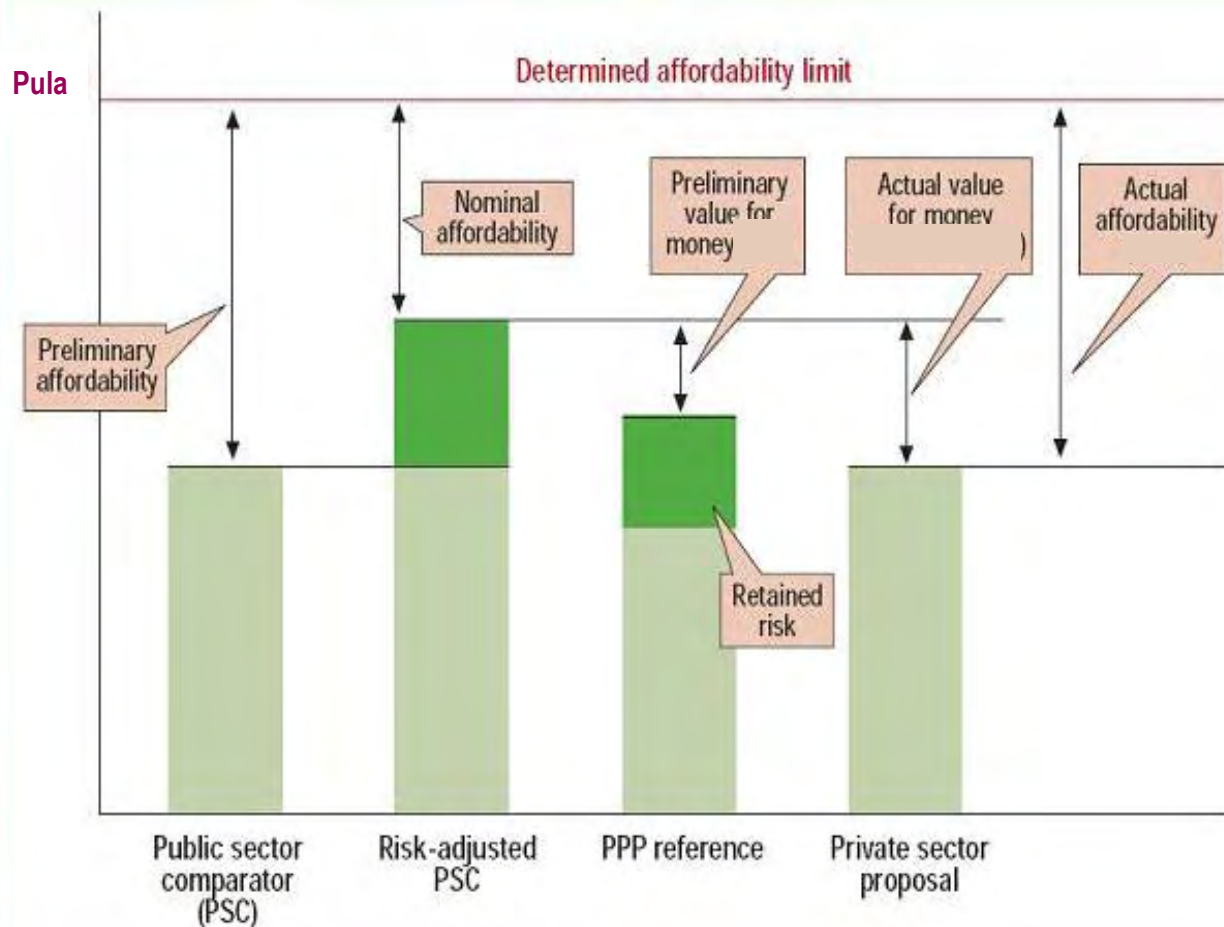

# Expressions of interest now



**GOVERNMENT OF BOTSWANA**  
PUBLIC-PRIVATE PARTNERSHIP  
BOTSWANA INTERNATIONAL UNIVERSITY  
OF SCIENCE & TECHNOLOGY

## Invitation for Expressions of Interest

The Government of Botswana invites private sector parties to submit expressions of interest for participation in a Public-Private Partnership for the design, construction, capital financing, and facility management of a new university: the Botswana International University for Science and Technology ("BIUST"). BIUST will be located in Palapye, 320 kilometers from the capital Gaborone. It is expected to reach a maximum enrollment of approximately 10,000 students by 2016, and serve as a regional center of excellence for tertiary science, and technology education and research.

The Government expects that consortia will be formed to respond to the anticipated tender, and that these consortia would likely comprise a mix of international, regional and local companies; lenders and investors with expertise in design, construction, facilities management, and education.

Interested parties are requested to submit a written Expression of Interest (EOI), to both emails listed below, which must include: (i) a profile of their company/group; (ii) a description of their financial position; (iii) a listing of relevant present and past projects; and, (iv) the name and details for the contact person at the company. In return, responding parties will receive additional preliminary information and notification of relevant events as scheduled. The deadline for submission is March 24, 2008.

IFC, a member of the World Bank Group, is advising the Government of Botswana on structuring of the Project and the selection of the private investor.

### Government of Botswana

Mrs. Badumetse D. Hobona  
BIUST Project Coordinator  
Ministry of Education  
Tel: +267 316 0707  
Email: bhobona@gov.bw

### IFC

Mr. Emmanuel B. Nyiririndi  
Advisory Services Department  
Johannesburg, South Africa  
Tel: +27 11 731 3068  
Email: biustppp@ifc.org



**International  
Finance Corporation**  
World Bank Group

# Current state of play

- University exists, searching for VC, Deans, Directors
- 27 staff in training internationally now, more to come
- Academic and other systems design under way
- Project management service provider for BIUSTout to tender
- EOI for prospective private providers out now, investor conference soon
- Feasibility studies for associated ventures (resort etc) to start soon
- Cabinet meets to consider and approve recommendation on option (public sector or PPP)
- Design and construct under way, ground break this year
- Marketing and student and recruitment start later this year
- Opens for commencement March 2010